



Stone Cottage



Stone Cottage

Mill Lane, Chideock, Dorset DT6 6JS

Seatown 0.75 Mile Bridport 3 Miles Lyme Regis 7 Miles

A very attractive, individual detached character style home with beautiful gardens well located to the south of Chideock village and just back from the Jurassic Coast.

- Attractive Character Style Home
- Very Flexible, Extensive Accommodation
- 4/5 Bedrooms
- 3/2 Reception Rooms, Conservatory
- Popular Village, Picturesque Setting
- Beautiful Private Gardens
- Stone & Thatched Store
- In All About 0.2 Acre
- Freehold
- Council Tax Band G

Guide Price £800,000

THE PROPERTY

Stone Cottage is a very attractive and highly individual detached cottage style house occupying a lovely setting in a back lane to the south of Chideock village and not far from Seatown and the Jurassic Coast. It is believed to date back to the 1600s with the original part being a barrel store to the neighbouring public house known as the Farmer's Arms which is now a private residence. Under the current ownership since 1987, the property was subject to extensive enlargement, alteration and complete refurbishment to create a lovely and very distinctive character home.

The accommodation is very spacious and flexible and all the principal rooms enjoy the lovely aspect over the beautiful well stocked gardens. Although very well presented and cared for over the long ownership, the property would now benefit from general updating.

Briefly the accommodation extends to:

Ground floor – reception hall, cloakroom, living room with fireplace incorporating a multi fuel stove, dining room, kitchen, utility, store room with puddle duck stairs to first floor occasional bedroom (under building regulations, it is not a habitable room), conservatory, study/fifth bedroom.

First floor – landing with walk in airing cupboard and access to loft space, principle bedroom with a very large en-suite bathroom/shower room, three further bedrooms, bathroom.



OUTSIDE

Stone Cottage offers very good parking facilities with potential for garaging if required.

There is a large paved driveway with parking area to the front which extends to the side and through double five bar gates onto an inner parking area, workshop and greenhouse. The beautiful, well stocked and private gardens are undoubtedly a further big feature of the property.

There are extensive areas of lawn interspersed with a wide variety of flower and shrub beds plus apple trees and specimen trees. Immediately adjoining the property is a wide and sheltered paved terrace.

Within the gardens is a detached stone and thatched store known as 'The Barn' which is Grade 2 Listed (Stone Cottage itself is not Listed) and there is also a revolving timber summerhouse, giving the ability to follow the sun.

The eastern boundary leads down and adjoins the River Winniford with the delightful sound of running water.

SITUATION

Stone Cottage enjoys an extremely peaceful and picturesque setting in a sought after back lane to the south of Chideock village centre only 5 minutes' walk from the centre and amenities. Chideock village is very popular and picturesque, principally made up of period houses and thatched cottages of the type for which the area is well known. The excellent local facilities include a shop/post office, two public houses, Parish Church and village hall. The immediate area is designated as one of Outstanding Natural Beauty (AONB). The stunning World Heritage Jurassic Coast is only about 3/4 mile away at Seatown with access to the beach, spectacular cliff and coastal walks and the National Trust Golden Cap Estate. The thriving Georgian market town of Bridport is just to the east providing comprehensive facilities and the pretty historic resort of Lyme Regis is to the west, famous for its Cobb. Dorchester and Axminster (the latter, only 10 minutes' drive) both have mainline rail services to London Waterloo. The city of Exeter is within about 45 minutes' drive.

SERVICES

All mains services. Gas fired central heating.

DIRECTIONS

From Bridport, follow the A35 West to Chideock. Continue through the village and at the Church, turn left signed Seatown. After about 1/5 mile, turn left into Mill Lane and Stone Cottage can be seen after about 300 yards on the left.



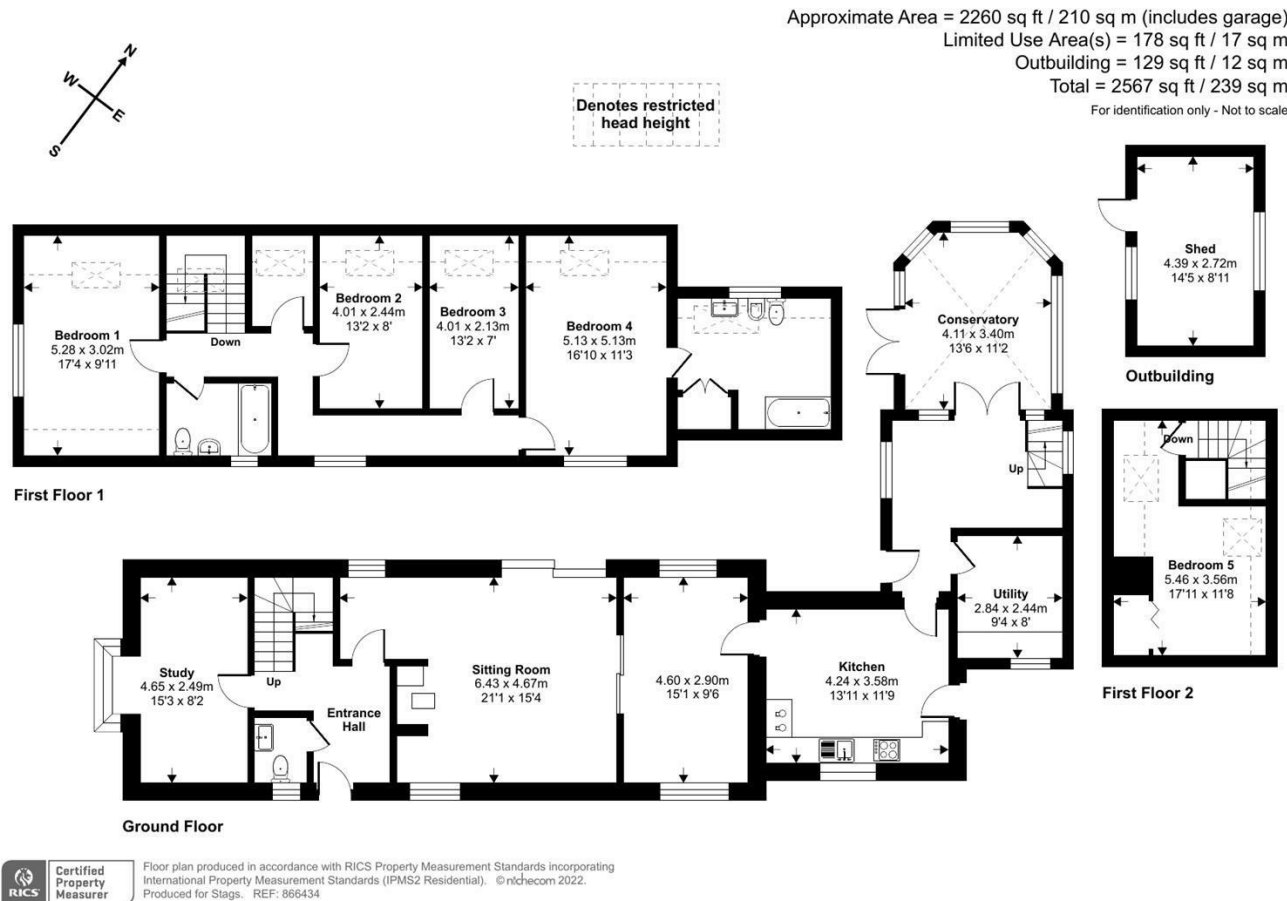

32 South Street, Bridport, Dorset, DT6 3NQ

bridport@stags.co.uk

01308 428000



@StagsProperty

Cornwall | Devon | Somerset | Dorset | London